

600 FLAT TOP BLOCK

DESCRIPTION	METRIC
• Width	600 mm
• Height	600 mm
• Depth	600 mm
• Face Area	0.36 m ²
• Volume (±)	0.206 m ³
• Weight (±)	500 kg

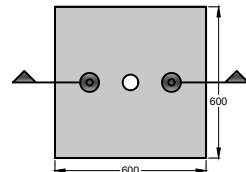

PLAN

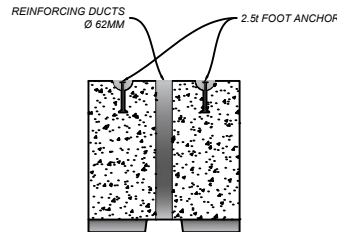

CROSS SECTION

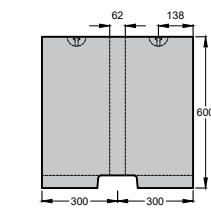

FRONT ELEVATION

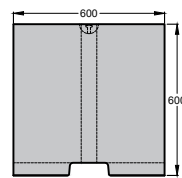

SIDE ELEVATIONS

600 STANDARD BLOCK

DESCRIPTION	METRIC
• Width	600 mm
• Height	600 mm
• Depth	600 mm
• Face Area	0.36 m ²
• Volume (±)	0.214 m ³
• Weight (±)	500 kg

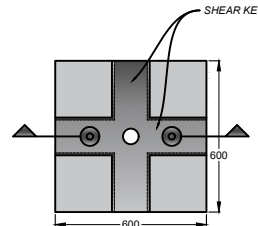

PLAN

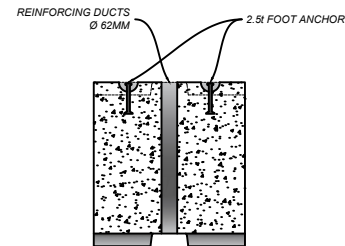

CROSS SECTION

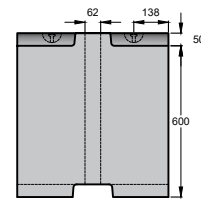

FRONT ELEVATION

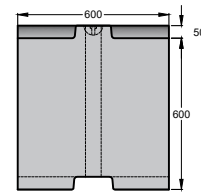

SIDE ELEVATIONS

600 FLAT BOTTOM BLOCK

DESCRIPTION	METRIC
• Width	600 mm
• Height	600 mm
• Depth	600 mm
• Face Area	0.36 m ²
• Volume (±)	0.221 m ³
• Weight (±)	500 kg

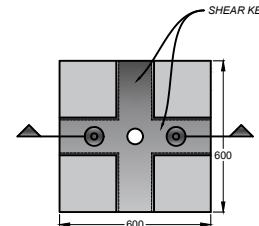

PLAN

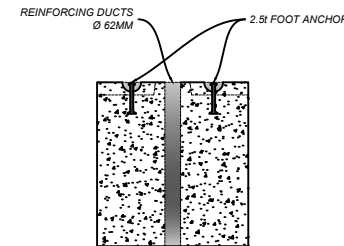

CROSS SECTION

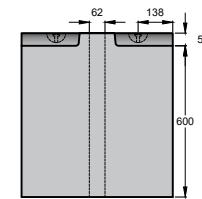

FRONT ELEVATION

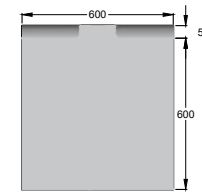

SIDE ELEVATIONS

600 HALF HIGH FLAT TOP CAPPER

DESCRIPTION	METRIC
• Width	600 mm
• Height	297 mm
• Depth	600 mm
• Face Area	0.18 m ²
• Volume (±)	0.096 m ³
• Weight (±)	220 kg

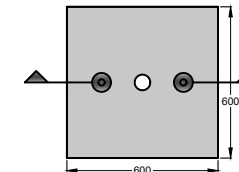

PLAN

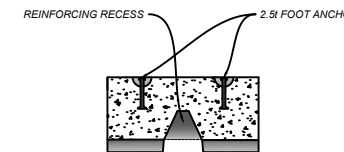

CROSS SECTION

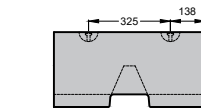

FRONT ELEVATION

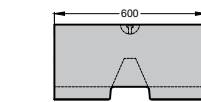

SIDE ELEVATIONS

GENERAL NOTES:

These drawings are provided solely as preliminary guidance for wall design and are not suitable for final design or construction without further evaluation.

All site-specific walls must be certified and approved by an engineer licensed in the region where construction will occur, in accordance with New Zealand Standards and relevant building codes. Where applicable, building consent should also be obtained.

The user assumes full responsibility for verifying the accuracy and proper application of the details provided in this document.

Density Standards for Weight and Volume Calculations:

Concrete densities typically range from 2200 to 2500 kg/m³ in accordance with standard construction practices. It is important to note that variations in dimensions of 1 to 3 mm may result in different volume calculations, which can subsequently affect the estimated weight. These values are provided as estimates, as actual weights may vary based on the specific concrete mix used, any additives, and adherence to relevant New Zealand standards and policies.

Concrete Type:

Interbloc is primarily manufactured using high quality, certified, excess concrete. 100% of blocks are 20MPA or greater, and 50% of blocks are 30MPA or greater. Concrete is tracked from source and each block carries a unique barcode for tracking. You can find out more information about this in our articles on excess concrete, and quality.

Foot Anchor:

2.5t x 120mm SwiftLift™ Foot Anchor
1.3t x 120mm SwiftLift™ Foot Anchor
Compliance: NZ GPG 2018
System: Fully engineered with cast-in lifting anchors, recess formers, and lifting clutches
Working Load Limit (WLL): 2.5 or 1.3 tons
Factor of Safety (FoS): 4 for high tensile steel, exceeding NZ GPG 2018 minimum requirements

TITLE:
INTERBLOC® Product Specification and Reference Sheet



- Drawn by Sam Salari
- Checked by Sam Salari
- Approved by
- Scale @ A3 1:300
- Date 11/11/2024
- Sheet IB-01

ENVIROCON
CAPTURING CONCRETE EXCESS
ENVIROBUILD INTERBLOC

www.envirocon.co.nz
www.envirobuild.co.nz
Address: 667B Great South Road,
Penrose, Auckland 1061
Phone: 0800 468 375

1200 FLAT TOP BLOCK

DESCRIPTION	METRIC
• Width	1200 mm
• Height	600 mm
• Depth	600 mm
• Face Area	0.72 m ²
• Volume (±)	0.413 m ³
• Weight (±)	1.00 TN



1200 STANDARD BLOCK

DESCRIPTION	METRIC
• Width	1200 mm
• Height	600 mm
• Depth	600 mm
• Face Area	0.72 m ²
• Volume (±)	0.428m ³
• Weight (±)	1.00 TN



1200 FLAT BOTTOM BLOCK

DESCRIPTION	METRIC
• Width	1200 mm
• Height	600 mm
• Depth	600 mm
• Face Area	0.72 m ²
• Volume (±)	0.443 m ³
• Weight (±)	1.00 TN



1200 HALF HIGH FLAT TOP CAPPER

DESCRIPTION	METRIC
• Width	1200 mm
• Height	297 mm
• Depth	600 mm
• Face Area	0.36 m ²
• Volume (±)	0.192 m ³
• Weight (±)	440 kg

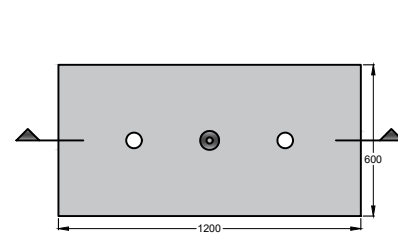

PLAN

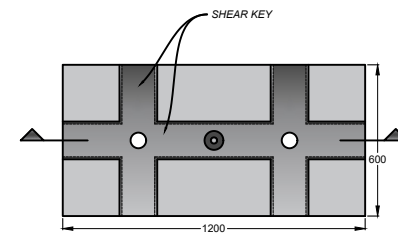

PLAN

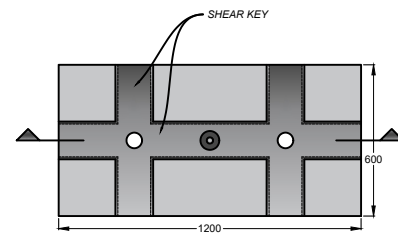

PLAN

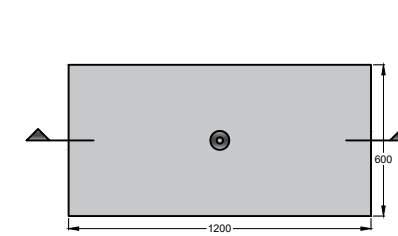

PLAN

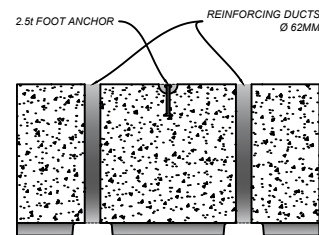

CROSS SECTION

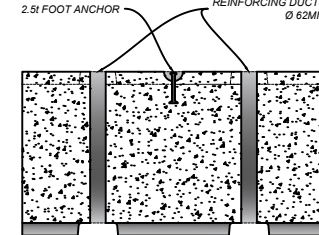

CROSS SECTION

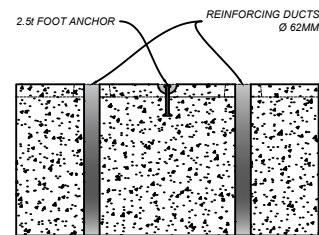

CROSS SECTION

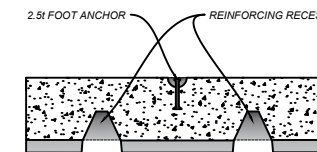

CROSS SECTION

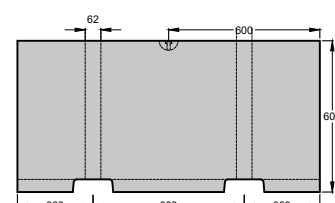

FRONT ELEVATION

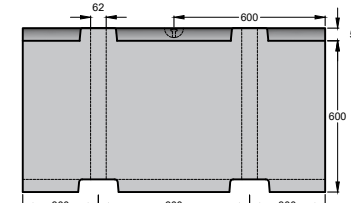

FRONT ELEVATION

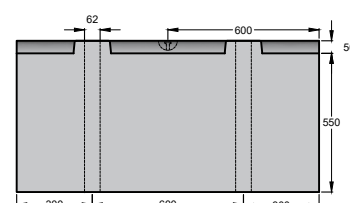

FRONT ELEVATION

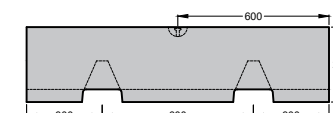

FRONT ELEVATION

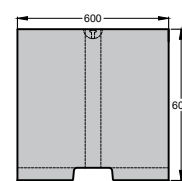

SIDE ELEVATIONS

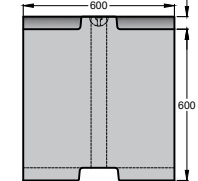

SIDE ELEVATIONS

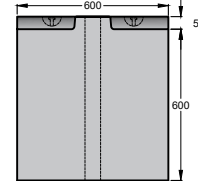

SIDE ELEVATIONS

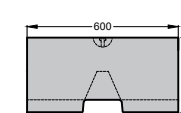

SIDE ELEVATIONS

GENERAL NOTES:

These drawings are provided solely as preliminary guidance for wall design and are not suitable for final design or construction without further evaluation.

All site-specific walls must be certified and approved by an engineer licensed in the region where construction will occur, in accordance with New Zealand Standards and relevant building codes. Where applicable, building consent should also be obtained.

The user assumes full responsibility for verifying the accuracy and proper application of the details provided in this document.

Density Standards for Weight and Volume Calculations:

Concrete densities typically range from 2200 to 2500 kg/m³ in accordance with standard construction practices. It is important to note that variations in dimensions of 1 to 3 mm may result in different volume calculations, which can subsequently affect the estimated weight. These values are provided as estimates, as actual weights may vary based on the specific concrete mix used, any additives, and adherence to relevant New Zealand standards and policies.

Concrete Type:

Interbloc is primarily manufactured using high quality, certified, excess concrete. 100% of blocks are 20MPa or greater, and 50% of blocks are 30MPa or greater. Concrete is tracked from source and each block carries a unique barcode for tracking. You can find out more information about this in our articles on excess concrete, and quality.

Foot Anchor:

2.5t x 120mm SwiftLift™ Foot Anchor
1.3t x 120mm SwiftLift™ Foot Anchor
Compliance: NZ GPG 2018
System: Fully engineered with cast-in lifting anchors, recess formers, and lifting clutches
Working Load Limit (WLL): 2.5 or 1.3 tons
Factor of Safety (FoS): 4 for high tensile steel, exceeding NZ GPG 2018 minimum requirements

TITLE:
INTERBLOC® Product Specification and Reference Sheet

- Drawn by Sam Salari
- Checked by Sam Salari
- Approved by Sam Salari
- Scale @ A3 1:300
- Date 11/11/2024
- Sheet IB-02



www.envirocon.co.nz
www.envirobuild.co.nz
Address: 667B Great South Road,
Penrose, Auckland 1061
Phone: 0800 468 375

1800 FLAT TOP BLOCK

DESCRIPTION METRIC

- Width 1800 mm
- Height 600 mm
- Depth 600 mm
- Face Area 1.08 m²
- Volume (±) 0.620 m³
- Weight (±) 1.50 TN

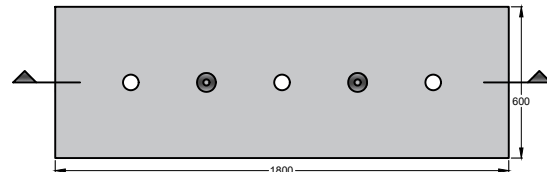

PLAN

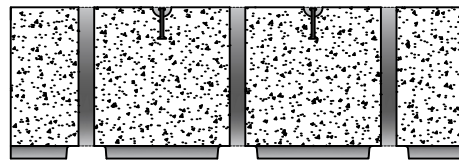

CROSS SECTION

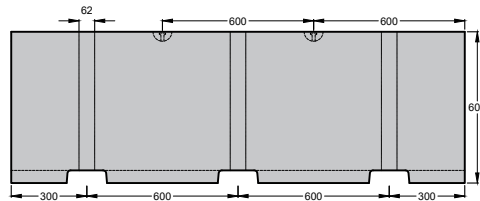

FRONT ELEVATION

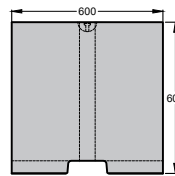

SIDE ELEVATIONS

1800 STANDARD BLOCK

DESCRIPTION METRIC

- Width 1800 mm
- Height 600 mm
- Depth 600 mm
- Face Area 1.08 m²
- Volume (±) 0.642 m³
- Weight (±) 1.50 TN

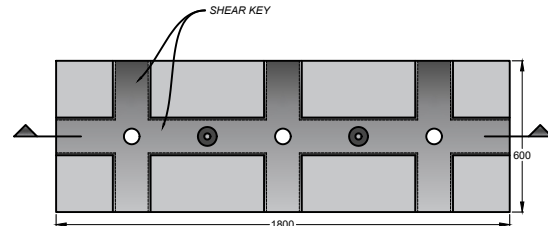

PLAN

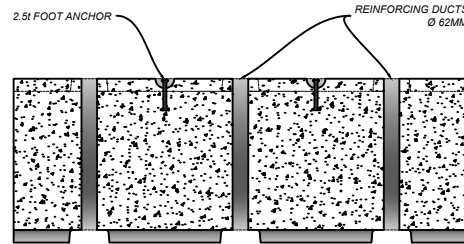

CROSS SECTION

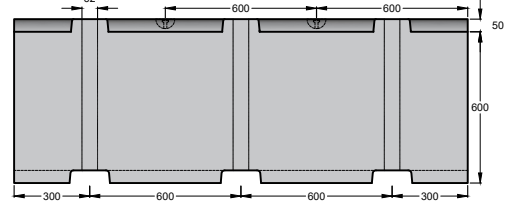

FRONT ELEVATION

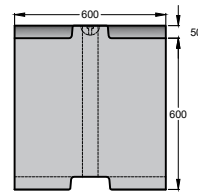

SIDE ELEVATIONS

1800 STANDARD BLOCK

DESCRIPTION METRIC

- Width 1800 mm
- Height 600 mm
- Depth 600 mm
- Face Area 1.08 m²
- Volume (±) 0.665 m³
- Weight (±) 1.50 TN

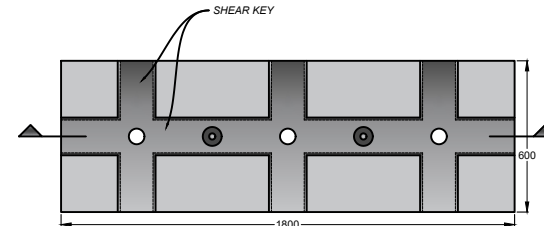

PLAN

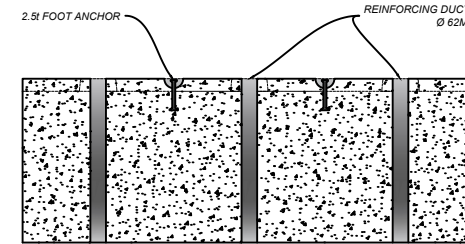

CROSS SECTION

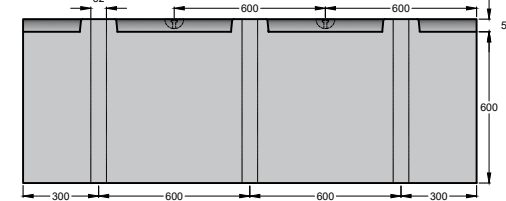

FRONT ELEVATION

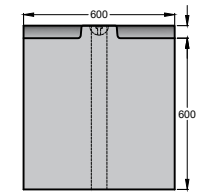

SIDE ELEVATIONS

GENERAL NOTES:

These drawings are provided solely as preliminary guidance for wall design and are not suitable for final design or construction without further evaluation.

All site-specific walls must be certified and approved by an engineer licensed in the region where construction will occur, in accordance with New Zealand Standards and relevant building codes. Where applicable, building consent should also be obtained.

The user assumes full responsibility for verifying the accuracy and proper application of the details provided in this document.

Density Standards for Weight and Volume Calculations:

Concrete densities typically range from 2200 to 2500 kg/m³ in accordance with standard construction practices. It is important to note that variations in dimensions of 1 to 3 mm may result in different volume calculations, which can subsequently affect the estimated weight. These values are provided as estimates, as actual weights may vary based on the specific concrete mix used, any additives, and adherence to relevant New Zealand standards and policies.

Concrete Type:

Interbloc is primarily manufactured using high quality, certified, excess concrete. 100% of blocks are 20MPA or greater, and 50% of blocks are 30MPA or greater. Concrete is tracked from source and each block carries a unique barcode for tracking. You can find out more information about this in our articles on excess concrete, and quality.

Foot Anchor:

2.5t x 120mm SwiftLift™ Foot Anchor
1.3t x 120mm SwiftLift™ Foot Anchor
Compliance: NZ GPG 2018
System: Fully engineered with cast-in lifting anchors, recess formers, and lifting clutches
Working Load Limit (WLL): 2.5 or 1.3 tons
Factor of Safety (FoS): 4 for high tensile steel, exceeding NZ GPG 2018 minimum requirements

TITLE:
INTERBLOC® Product Specification and Reference Sheet



- Drawn by Sam Salari
- Checked by Sam Salari
- Approved by
- Scale @ A3 1:300
- Date 11/11/2024
- Sheet IB-03

ENVIROCON
CAPTURING CONCRETE EXCESS
ENVIROBUILD INTERBLOC

www.envirocon.co.nz
www.envirobuild.co.nz
Address: 667B Great South Road,
Penrose, Auckland 1061
Phone: 0800 468 375

1200 BASE BLOCK

DESCRIPTION	METRIC
• Width	1200 mm
• Height	600 mm
• Depth	600 mm
• Face Area	0.58 m ²
• Volume (±)	0.339 m ³
• Weight (±)	780 kg

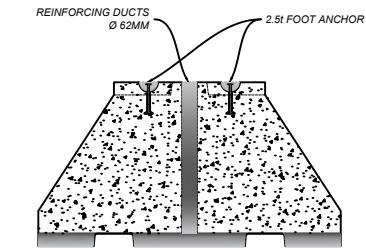
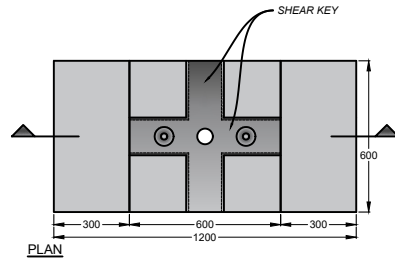

CROSS SECTION

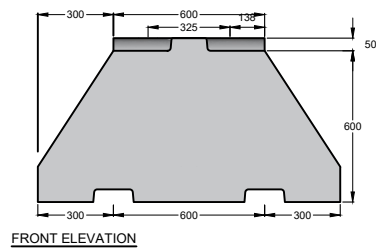

FRONT ELEVATION

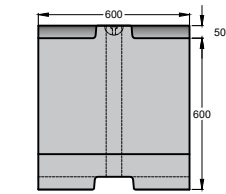

SIDE ELEVATIONS

1200 ANGLED CAPPER BLOCKS

DESCRIPTION	METRIC
• Width	1200 mm
• Height	600 mm
• Depth	600 mm
• Face Area	0.72 m ²
• Volume (±)	0.254m ³
• Weight (±)	585 kg

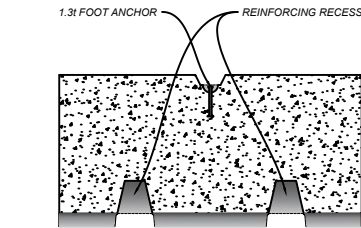
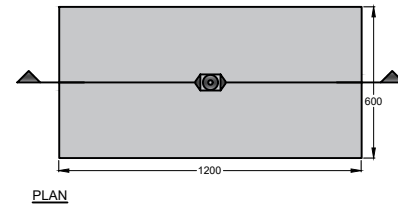
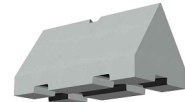

CROSS SECTION

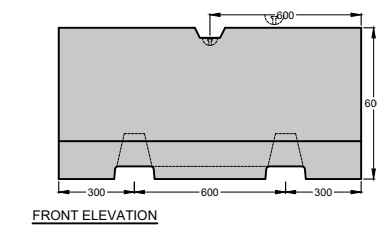

FRONT ELEVATION

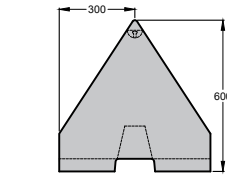

SIDE ELEVATIONS

600 ANGLED CAPPER BLOCKS

DESCRIPTION	METRIC
• Width	1200 mm
• Height	600 mm
• Depth	600 mm
• Face Area	0.36 m ²
• Volume (±)	0.127 m ³
• Weight (±)	290 kg

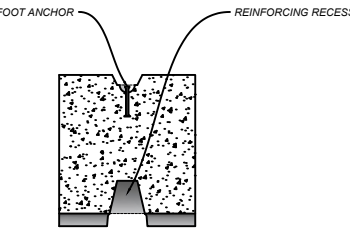
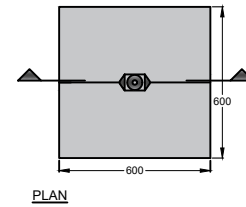
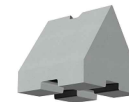

CROSS SECTION

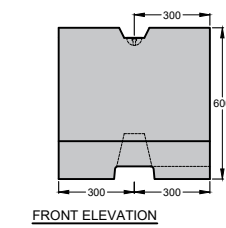

FRONT ELEVATION

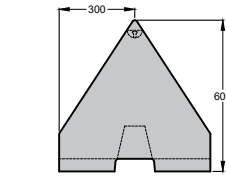

SIDE ELEVATIONS

600 ANGLE BLOCK

DESCRIPTION	METRIC
• Width	1200 mm
• Height	600 mm
• Depth	600 mm
• Face Area	0.18 m ²
• Volume (±)	0.100 m ³
• Weight (±)	230 kg

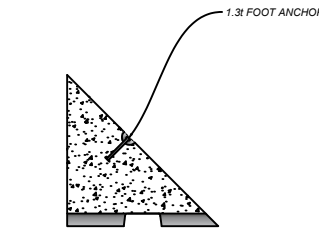
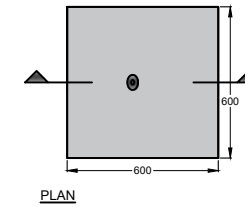

CROSS SECTION

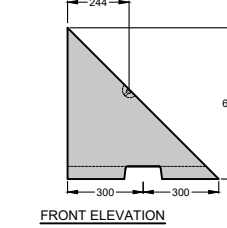

FRONT ELEVATION

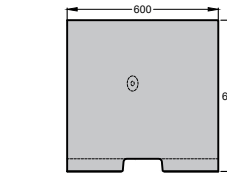

SIDE ELEVATIONS

GENERAL NOTES:

These drawings are provided solely as preliminary guidance for wall design and are not suitable for final design or construction without further evaluation.

All site-specific walls must be certified and approved by an engineer licensed in the region where construction will occur, in accordance with New Zealand Standards and relevant building codes. Where applicable, building consent should also be obtained.

The user assumes full responsibility for verifying the accuracy and proper application of the details provided in this document.

Density Standards for Weight and Volume Calculations:

Concrete densities typically range from 2200 to 2500 kg/m³ in accordance with standard construction practices. It is important to note that variations in dimensions of 1 to 3 mm may result in different volume calculations, which can subsequently affect the estimated weight. These values are provided as estimates, as actual weights may vary based on the specific concrete mix used, any additives, and adherence to relevant New Zealand standards and policies.

Concrete Type:

Interbloc is primarily manufactured using high quality, certified, excess concrete. 100% of blocks are 20MPa or greater, and 50% of blocks are 30MPa or greater. Concrete is tracked from source and each block carries a unique barcode for tracking. You can find out more information about this in our articles on excess concrete, and quality.

Foot Anchor:

2.5t x 120mm SwiftLift™ Foot Anchor
1.3t x 120mm SwiftLift™ Foot Anchor
Compliance: NZ GPG 2018
System: Fully engineered with cast-in lifting anchors, recess formers, and lifting clutches
Working Load Limit (WLL): 2.5 or 1.3 tons
Factor of Safety (FoS): 4 for high tensile steel, exceeding NZ GPG 2018 minimum requirements

TITLE:
INTERBLOC® Product Specification and Reference Sheet

- Drawn by Sam Salari
- Checked by Sam Salari
- Approved by
- Scale @ A3 1:300
- Date 11/11/2024
- Sheet IB-04



www.envirocon.co.nz
www.envirobuild.co.nz
Address: 667B Great South Road,
Penrose, Auckland 1061
Phone: 0800 468 375

600 FLAT TOP RECESS BLOCK

DESCRIPTION	METRIC
• Width	600 mm
• Height	600 mm
• Depth	600 mm
• Face Area	0.36 m ²
• Volume(±)	0.205 m ³
• Weight (±)	470 kg

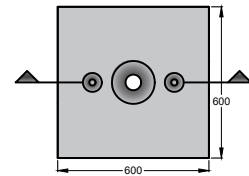

PLAN

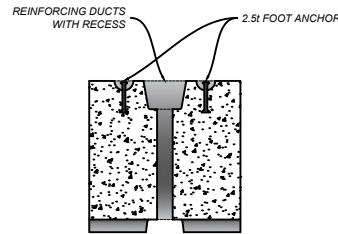

CROSS SECTION

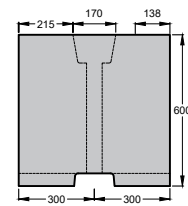

FRONT ELEVATION

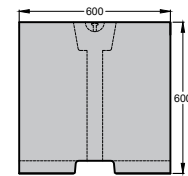

SIDE ELEVATIONS

600 HALF HIGH FLAT TOP RECESS BLOCK

DESCRIPTION	METRIC
• Width	600 mm
• Height	297 mm
• Depth	600 mm
• Face Area	0.18 m ²
• Volume(±)	0.097 m ³
• Weight (±)	225 kg

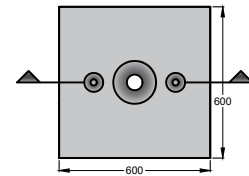

PLAN

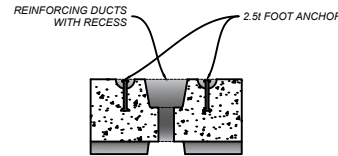

CROSS SECTION

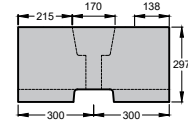

FRONT ELEVATION

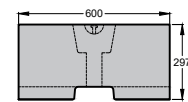

SIDE ELEVATIONS

1200 FLAT TOP RECESS BLOCK

DESCRIPTION	METRIC
• Width	1200 mm
• Height	600 mm
• Depth	600 mm
• Face Area	0.72 m ²
• Volume (±)	410 m ³
• Weight (±)	0.94 TN

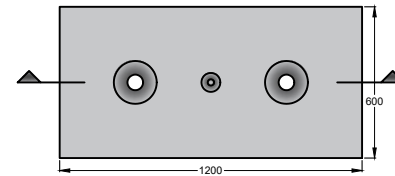

PLAN

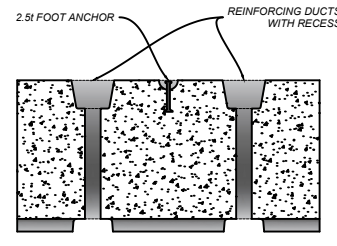

CROSS SECTION

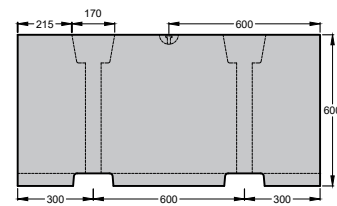

FRONT ELEVATION

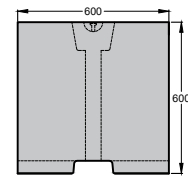

SIDE ELEVATIONS

1200 HALF HIGH FLAT TOP RECESS BLOCK

DESCRIPTION	METRIC
• Width	1200 mm
• Height	297 mm
• Depth	600 mm
• Face Area	0.36 m ²
• Volume (±)	0.192 m ³
• Weight (±)	440 kg

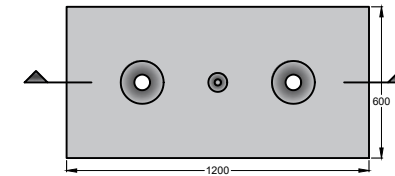
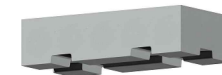

PLAN

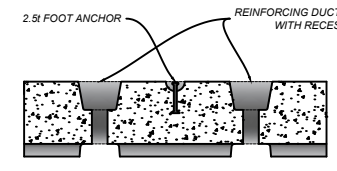

CROSS SECTION

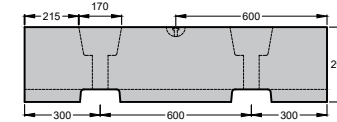

FRONT ELEVATION

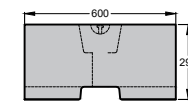

SIDE ELEVATIONS

GENERAL NOTES:

These drawings are provided solely as preliminary guidance for wall design and are not suitable for final design or construction without further evaluation.

All site-specific walls must be certified and approved by an engineer licensed in the region where construction will occur, in accordance with New Zealand Standards and relevant building codes. Where applicable, building consent should also be obtained.

The user assumes full responsibility for verifying the accuracy and proper application of the details provided in this document.

Density Standards for Weight and Volume Calculations:

Concrete densities typically range from 2200 to 2500 kg/m³ in accordance with standard construction practices. It is important to note that variations in dimensions of 1 to 3 mm may result in different volume calculations, which can subsequently affect the estimated weight. These values are provided as estimates, as actual weights may vary based on the specific concrete mix used, any additives, and adherence to relevant New Zealand standards and policies.

Concrete Type:

Interbloc is primarily manufactured using high quality, certified, excess concrete. 100% of blocks are 20MPa or greater, and 50% of blocks are 30MPa or greater. Concrete is tracked from source and each block carries a unique barcode for tracking. You can find out more information about this in our articles on excess concrete, and quality.

Foot Anchor:

2.5t x 120mm SwiftLift™ Foot Anchor
1.3t x 120mm SwiftLift™ Foot Anchor
Compliance: NZ GPG 2018
System: Fully engineered with cast-in lifting anchors, recess formers, and lifting clutches
Working Load Limit (WLL): 2.5 or 1.3 tons
Factor of Safety (FoS): 4 for high tensile steel, exceeding NZ GPG 2018 minimum requirements

TITLE:
INTERBLOC® Product Specification
and Reference Sheet



- Drawn by Sam Salari
- Checked by Sam Salari
- Approved by
- Scale @ A3 1:300
- Date 11/11/2024
- Sheet IB-05

ENVIROCON
CAPTURING CONCRETE EXCESS
ENVIROBUILD INTERBLOC

www.envirocon.co.nz
www.envirobuild.co.nz
Address: 667B Great South Road,
Penrose, Auckland 1061
Phone: 0800 468 375

1800 FLAT TOP RECESS BLOCK

DESCRIPTION METRIC

- Width 1800 mm
- Height 600 mm
- Depth 600 mm
- Face Area 1.08 m²
- Volume (±) 0.615 m³
- Weight (±) 1.415 TN

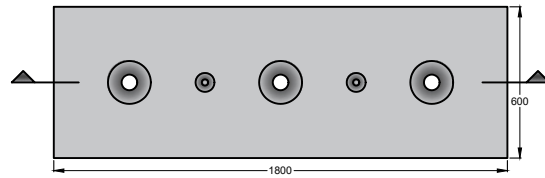

PLAN

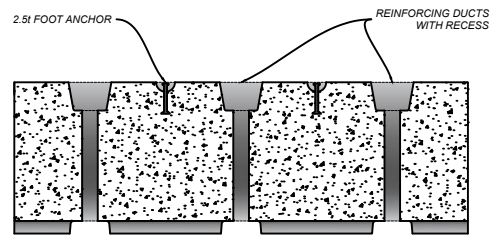

CROSS SECTION

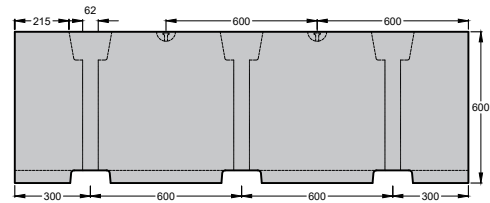

FRONT ELEVATION

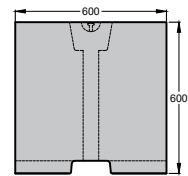

SIDE ELEVATIONS

GENERAL NOTES:

These drawings are provided solely as preliminary guidance for wall design and are not suitable for final design or construction without further evaluation.

All site-specific walls must be certified and approved by an engineer licensed in the region where construction will occur, in accordance with New Zealand Standards and relevant building codes. Where applicable, building consent should also be obtained.

The user assumes full responsibility for verifying the accuracy and proper application of the details provided in this document.

Density Standards for Weight and Volume Calculations:

Concrete densities typically range from 2200 to 2500 kg/m³ in accordance with standard construction practices. It is important to note that variations in dimensions of 1 to 3 mm may result in different volume calculations, which can subsequently affect the estimated weight. These values are provided as estimates, as actual weights may vary based on the specific concrete mix used, any additives, and adherence to relevant New Zealand standards and policies.

Concrete Type:

Interbloc is primarily manufactured using high quality, certified, excess concrete. 100% of blocks are 20MPa or greater, and 50% of blocks are 30MPa or greater. Concrete is tracked from source and each block carries a unique barcode for tracking. You can find out more information about this in our articles on excess concrete, and quality.

Foot Anchor:

2.5t x 120mm SwiftLift™ Foot Anchor
 1.3t x 120mm SwiftLift™ Foot Anchor
 Compliance: NZ GPG 2018
 System: Fully engineered with cast-in lifting anchors, recess formers, and lifting clutches
 Working Load Limit (WLL): 2.5 or 1.3 tons
 Factor of Safety (FoS): 4 for high tensile steel, exceeding NZ GPG 2018 minimum requirements

TITLE:
INTERBLOC® Product Specification and Reference Sheet



- Drawn by Sam Salari
- Checked by Sam Salari
- Approved by Sam Salari
- Scale @ A3 1:300
- Date 11/11/2024
- Sheet IB-06



www.envirocon.co.nz
 www.envirobuild.co.nz
 Address: 667B Great South Road,
 Penrose, Auckland 1061
 Phone: 0800 468 375